

PLAN URBANISTIC ZONAL
03 - SITUATIA EXISTENTA
" Spatii de productie , prestari servicii si logistica "
Calea Bodrogului Nr 24/C; 24/B - Arad - jud.Arad

BILANT TERITORIAL ZONA STUDIATA

FUNCTIUNI	EXISTENT	
	SUPRAFATA	%
TEREN ARABIL - INTRAVILAN	74.235,00	78,30 %
DRUM JUDETEAN 682F	1.688,00	1,78 %
SP. VERZI NEAMENAJATE	838,00	0,89 %
SP. VERZI AMENAJATE - TALUZ	3.132,00	3,30 %
PADUREA CEALA	2.224,00	2,35 %
ZONA UNITATI INDUSTRIALE / DEPOZITARE - EXISTENTE	8.488,00	8,96 %
INSTITUTII ADMINISTRATIVE APELE ROMANE - EXISTENTE	3.628,00	3,82 %
PISTA BICICLETE - EXISTENTA	567,00	0,60 %
SPATII DE PRODUCTIE PREST. SERV.SI LOGISTICA - PROPUS	---	---
DRUMURI ,TROTUARE PARCARI PLATFORME-PROBUS	---	---
DRUMURI ACCES IN INCINTA -PROPUS	---	---
SP.VERZI IN INCINTA	---	---
TOTAL ZONA	94.800,00	100,00 %

POT existent = 1,25 %
CUT existent = 0,012

BILANT TERITORIAL INCINTA

FUNCTIUNI	EXISTENT	
	SUPRAFATA	%
TEREN ARABIL - INTRAVILAN	57.100,00	100,00 %
DRUM JUDETEAN 682F	---	---
SP. VERZI NEAMENAJATE	---	---
SP. VERZI AMENAJATE - TALUZ	---	---
PADUREA CEALA	---	---
ZONA UNITATI INDUSTRIALE / DEPOZITARE - EXISTENTE	---	---
INSTITUTII ADMINISTRATIVE APELE ROMANE - EXISTENTE	---	---
PISTA BICICLETE - EXISTENTA	---	---
SPATII DE PRODUCTIE PREST. SERV.SI LOGISTICA - PROPUS	---	---
DRUMURI ,TROTUARE PARCARI PLATFORME-PROBUS	---	---
DRUM ACCES IN INCINTA -PROPUS	---	---
SP.VERZI IN INCINTA	---	---
TOTAL ZONA	57.100,00	100,00 %

POT existent = 0,00 %
CUT existent = 0,00

Parcela (2)

Nr. Pct.	Coordonate pct.de contur		Lungimi laturi D(i,i+1)
	X [m]	Y [m]	
1	525802.155	212441.263	13.388
2	525802.802	212427.891	12.047
3	525803.401	212415.859	7.453
4	525803.771	212408.415	59.302
5	525806.631	212349.182	13.903
6	525806.912	212335.282	11.746
7	525807.867	212323.575	39.014
8	525809.755	212284.607	41.157
9	525811.674	212243.495	23.644
10	525812.882	212219.882	277.230
11	525535.899	212208.186	22.635
12	525535.500	212230.817	17.602
13	525533.075	212231.795	54.725
14	525607.724	212228.921	52.819
15	525604.752	212281.656	52.126
16	525552.628	212281.233	18.314
17	525534.332	212282.037	14.908
18	525534.039	212296.942	15.061
19	525533.744	212312.000	12.738
20	525533.580	212324.737	12.782
21	525533.413	212337.518	92.248
22	525531.454	212429.745	270.946

S(2)=57100.05mp P=1135.785m

c.f.nr.334206 - s= 23.869 mp
c.f.nr.334258 - s= 1.131 mp
c.f.nr.334210 - s= 7.000 mp
c.f.nr.348869 - s= 25.100 mp

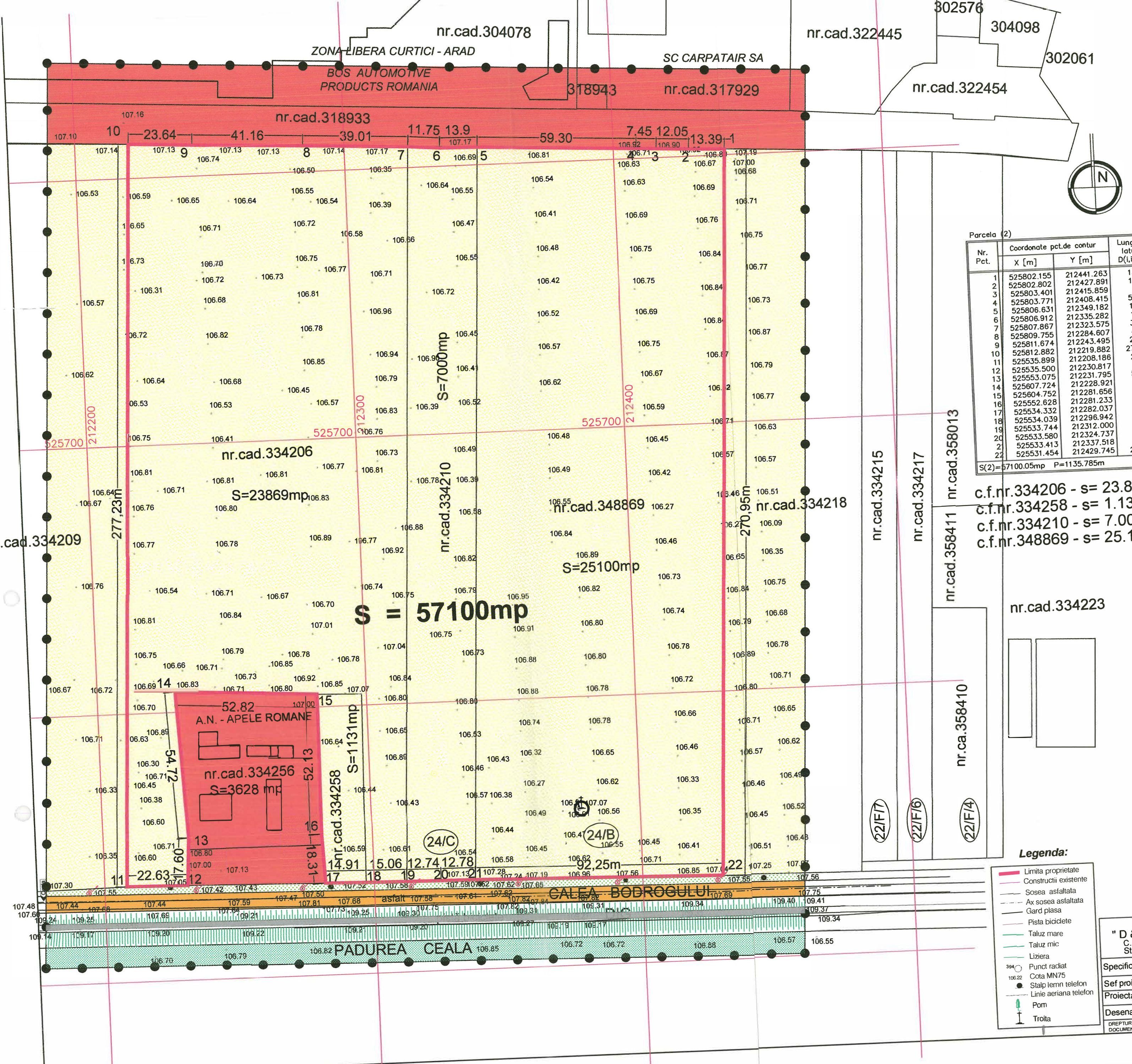

Legenda:

- Limita proprietate
- Constructii existente
- Sosea asfaltata
- Ax sosea asfaltata
- Gard plasa
- Pista biciclete
- Taluz mare
- Taluz mic
- Liziera
- Punct radiat
- Cota MN75
- Stalp lemn telefon
- Linie aeriana telefon
- Pom
- Troita

- LIMITA ZONEI STUDIATE
- LIMITA TERENULUI AFERENT INVESTITIEI
- CLADIRI EXISTENTE
- CLADIRI PROPUSE
- TEREN ARABIL
- INSTITUTII ADMINISTRATIVE
- IND.DEPOZITARE - EXISTENTE
- DRUM JUDETEAN 682F
- SP. VERZI NEAMENAJATE
- SP. VERZI AMENAJATE - TALUZ
- PADUREA CEALA



Societate comerciala " D & D DESIGN PROJECT " S.R.L. C.U.I. - 15768864 / J02/1214/2003 Str. Nicolae Grigorescu nr.7 - ARAD -		Beneficiar : Mot Ginel Adrian PRSOANA FIZICA AUTORIZATA str.Stinienel nr.16 - Arad -		Nr. Pr. P 1/2024
Specificatie	Nume	Semnatura	Scara : 1:1.000	Faza : P.U.Z.
Sef proiect	arh. M. Dinulescu		Data : iun. 2024	Plansa nr. 03/A
Proiectant	arh. Nagy-Vizitiu A		Titlu planşa : SITUATIA EXISTENTA	
Desenat	teh. M. Dinulescu			

DEPTURILE DE AUTOR PRIVIND PREZENTA DOCUMENTATIE APARTIN IN EXCLUSIVITATE S.C. "D & D DESIGN PROJECT" S.R.L. ARAD.
DOCUMENTATIA NU POATE FI REPRODUSA SAU REFOLOSITA LA ALTE DOCUMENTATII SIMILARE FARA ACORDUL AUTORULUI!