

**PLAN URBANISTIC ZONAL**  
**04 - REGLEMENTARI URBANISTICE**  
**- ZONIFICARE -**  
 " Spatii de productie , prestari servicii si logistica "  
 Calea Bodrogului Nr. 24/C; 24/B - Arad - jud.Arad

**BILANT TERITORIAL ZONA STUDIATA**

FUNCTIUNI	EXISTENT		PROPOS	
	SUPRAFATA	%	SUPRAFATA	%
TEREN ARABIL - INTRAVILAN	74.235,00	78,30 %	17.135,00	18,00 %
DRUM JUDETEAN 682 F	1.688,00	1,78 %	1.688,00	1,78 %
SP. VERZI NEAMENAJATE	838,00	0,89 %	722,00	0,76 %
SP. VERZI AMENAJATE - TALUZ	3.132,00	3,30 %	3.132,00	3,30 %
PADUREA CEALA	2.224,00	2,35 %	2.224,00	2,34 %
ZONA UNITATI INDUSTRIALE / DEPOZITARE - EXISTENTE	8.488,00	8,96 %	8.488,00	8,90 %
INSTITUTII ADMINISTRATIVE APELE ROMANE - EXISTENTE	3.628,00	3,82 %	3.628,00	3,82 %
PISTA BICICLETE - EXISTENTA	567,00	0,60 %	567,00	0,60 %
SPATII DE PRODUCTIE PREST. SERV.SI LOGISTICA - PROPOS CONST. ANEXE UTILITATI CONST. SPATII GOSPOD. CABINA POARTA , ETC -PROPOS	---	---	30.834,00	32,67%
DRUMURI , TROTUARE ,PARCARI,PLATFORME-PROPOS	---	---	14.846,00	15,66 %
DRUMURI ACCES IN INCINTA -PROPOS	---	---	116,00	0,13%
SP.VERZI IN INCINTA	---	---	11.420,00	12,04 %
<b>TOTAL ZONA</b>	<b>94.800,00</b>	<b>100,00 %</b>	<b>94.800,00</b>	<b>100,00 %</b>

POT existent = 1,25 %      POT propus = 32,90 %  
 CUT existent = 0,012      CUT propus = 0,42

**BILANT TERITORIAL INCINTA**

FUNCTIUNI	EXISTENT		PROPOS	
	SUPRAFATA	%	SUPRAFATA	%
TEREN ARABIL - INTRAVILAN	57.100,00	100,00 %	---	---
DRUM JUDETEAN 682F	---	---	---	---
SP. VERZI NEAMENAJATE	---	---	---	---
SP. VERZI AMENAJATE - TALUZ	---	---	---	---
PADUREA CEALA	---	---	---	---
ZONA UNITATI INDUSTRIALE / DEPOZITARE - EXISTENTE	---	---	---	---
INSTITUTII ADMINISTRATIVE APELE ROMANE - EXISTENTE	---	---	---	---
PISTA BICICLETE - EXISTENTA	---	---	---	---
SPATII DE PRODUCTIE, PREST. SERV.SI LOGISTICA - PROPOS CONST. ANEXE UTILITATI CONST. SPATII GOSPOD. CABINA POARTA , ETC -PROPOS	---	---	30.834,00	54,00 %
DRUMURI , TROTUARE ,PARCARI,PLATFORME-PROPOS	---	---	14.846,00	26,00 %
DRUM ACCES IN INCINTA -PROPOS	---	---	---	---
SP.VERZI IN INCINTA	---	---	11.420,00	20,00 %
<b>TOTAL ZONA</b>	<b>57.100,00</b>	<b>100,00 %</b>	<b>57.100,00</b>	<b>100,00 %</b>

POT existent = 0,00 %      POT propus = 54,00 %  
 CUT existent = 0,00      CUT propus = 0,70



- Legenda:**
- LIMITA ZONEI STUDIATE
  - LIMITA TERENULUI AFERENT INVESTITIEI
  - - - - - DELIMITARE INCINTA INTERIOARA
  - ▭ CLADIRI EXISTENTE
  - ▭ CLADIRI PROPUSE
  - ▭ TEREN ARABIL
  - ▭ INSTITUTII ADMINISTRATIVE
  - ▭ IND.DEPOZITARE - EXISTENE
  - ▭ DRUM JUDETEAN 682F
  - ▭ SP. VERZI NEAMENAJATE
  - ▭ SP. VERZI AMENAJATE - TALUZ
  - ▭ PADUREA CEALA
  - ▭ SPATII DE PRODUCTIE, PRESTARI SERVICII SI LOGISTICA - PROPOS
  - ▭ DRUMURI, TROTUARE, PARCARI, PLATFORME - PROPOS
  - ▭ DRUM ACCES IN INCINTA - PROPOS
  - ▭ SP. VERZI IN INCINTA
  - ▭ ZONA EDIFICABILA MIXTA SPATII DE PRODUCTIE, PRESTARI SERVICII SI LOGISTICA
  - ▭ ZONA PLATFORME GOSPODARESI I

- Limita proprietate
- Constructii existente
- Sosea asfaltata
- Ax sosea asfaltata
- Gard plasa
- Pista biciclete
- Taluz mare
- Taluz mic
- Liziera
- Punct radiat
- Cota MN75
- Stalp termn telefon
- Linie aeriana telefon
- Pom
- Troita

Societate comerciala <b>" D &amp; D DESIGN PROIECT " S.R.L.</b> C.U.I. - 15766864 / J02/1214/2003 Str. Nicolae Grigorescu nr.7 - ARAD -		Beneficiar : Mot Ginel Adrian PRSOANA FIZICA AUTORIZATA str.Stinjenel nr.16 - Arad -	Nr. Pr. P 1/2024
Specificatie	Nume	Semnatura	Scara : 1:1.000
Sef proiect	arh. M. Dinulescu		
Urbanism	arh. Nagy-Vizitiu A		
Desenat	teh. M. Dinulescu	Data : iun. 2024	Titlu planşa : REGLEMENTARI URBANISTICE - ZONIFICARE -
		Faza : P.U.Z.	
		Planşa nr. 04/A	

DRIFTURI E DE AUTOR PRIVIND PREZENTA DOCUMENTATIE APARTIN IN EXCLUSIVITATE S.C. " D & D DESIGN PROIECT " S.R.L. ARAD.  
 DOCUMENTATIA NU POATE FI REPRODUSA SAU REFOLOSITA LA ALTE DOCUMENTATI SIMILARE FARA ACORDUL AUTORULUI.

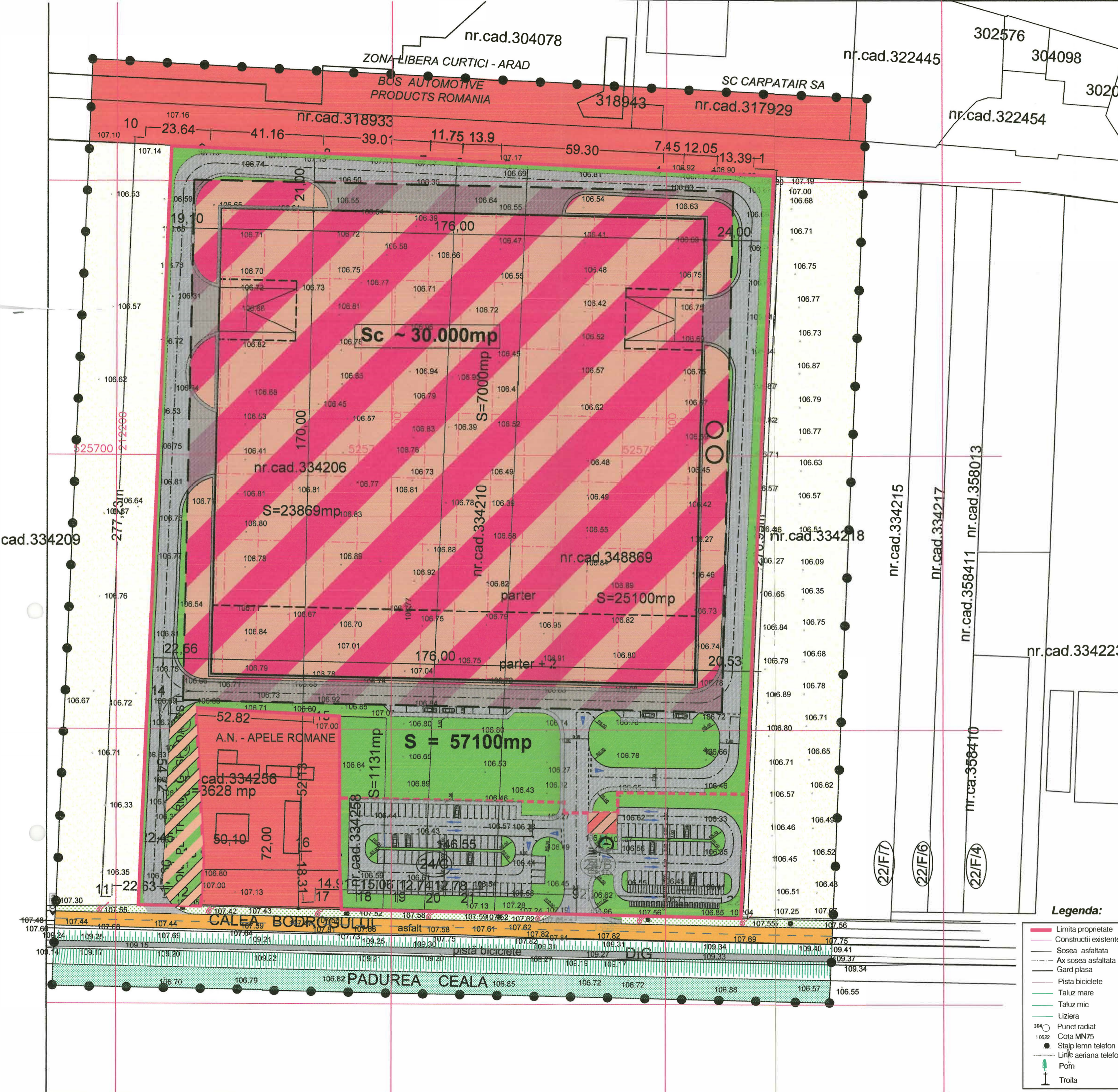

ORDINUL APPLICABIL  
 DIN ROMANIA  
 6576  
 Stelian Maria  
 DINULESCU

